

AC-2050

AC-2100

AC-2070

AC-2120



ACOUSTIC COLUMNS "STYL serie"

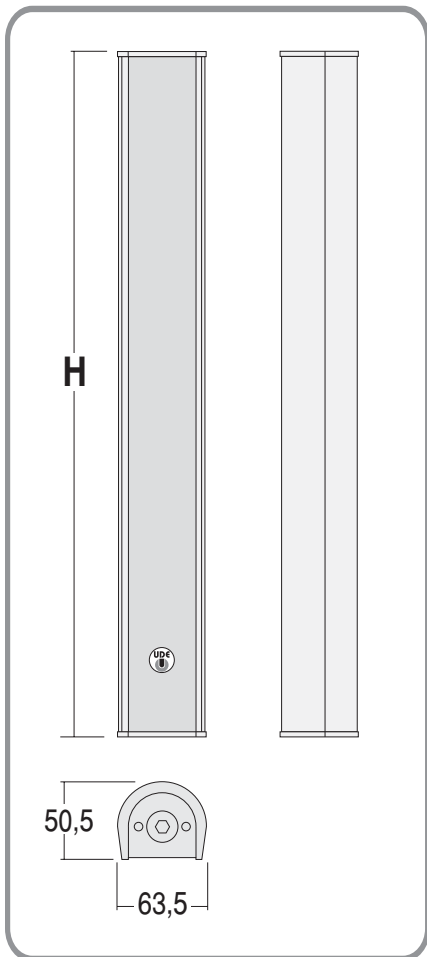

REFERENCE	H mm.	COLOUR
AC-2050	434	Ivory RAL 1013
AC-2070	662	
AC-2100	952	
AC-2120	1180	

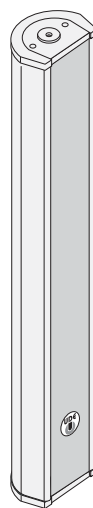

AC-2050

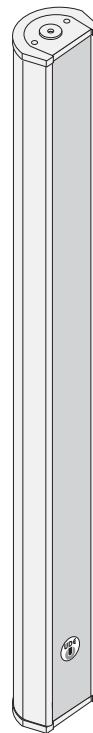

AC-2070

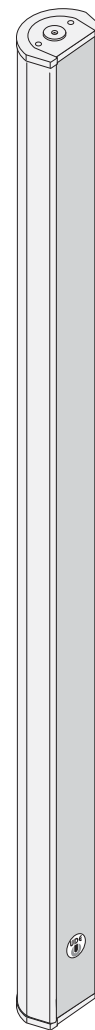

AC-2100

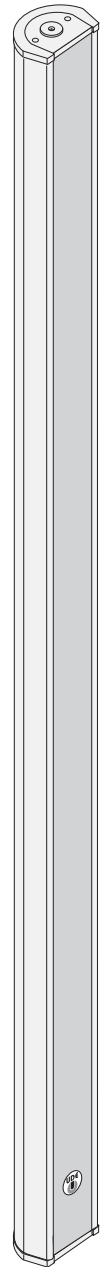

AC-2120

Electroacústica



www.udeaudio.com

Main Office Avda. BARCELONA, 24
08970 - SANT JOAN DESPÍ
BARCELONA - ESPAÑA
Tel: 34-93 477 28 54
Fax: 34-93 261 17 52
ude@udeaudio.com

Madrid Delegation C/ LUIS I, 88, 3ª planta
28031 - MADRID
ESPAÑA
Tel: 34-91 311 60 76
Fax: 34-91 450 19 97
centro@udeaudio.com



UDE reserves the right to modify the technical characteristics of its products without previous notice

DESCRIPTION

The **STYL** columns have the characteristics common to this type of loudspeaker in terms of directionality, voice reproduction, and an excellent musical performance.

Thanks to this electro-acoustically and structurally innovative desing, to say nothing of the materials used, **STYL** columns offer top-quality features and an excellent visual appel which combines very well with classical and modern architectural elements.

63,5 mm. wide and 50,5 mm., deep is the range of column the narrowest on the market.

Their rounded-off profile is prolonged vertically, giving four column models (which come in heights 434, 662, 952 and 1180 mm.) with a truly outstanding stylised and slim line.

Furthermore, in keeping with modern trends, the manufacturing materials used are recyclable.

The case is made of lacquered aluminium combined with moulded thermoplastic ABS parts.

The fixing plates are made of galvanised and painted steel.

Fixing to the plates is by stainless steel screws.

The high acoustic perfomance, plus the frequency response obtained in this range of **STYL** columns, is attained by dint of a well-conceived and meticulous desing, using truly novel elements such as:

- Anti vibration internal device.
- Large frequency response impedance transformer.
- Easy-to-connect device with rationalised power adjustment, which simplifies the installation of the column.

All of which has brought us the **STYL** range of columns, boasting three essential festures:

- **Voice intelligibility.**
- **Reliability.**
- **Architectural aesthetic.**

MOUNTING AND CONNECTION

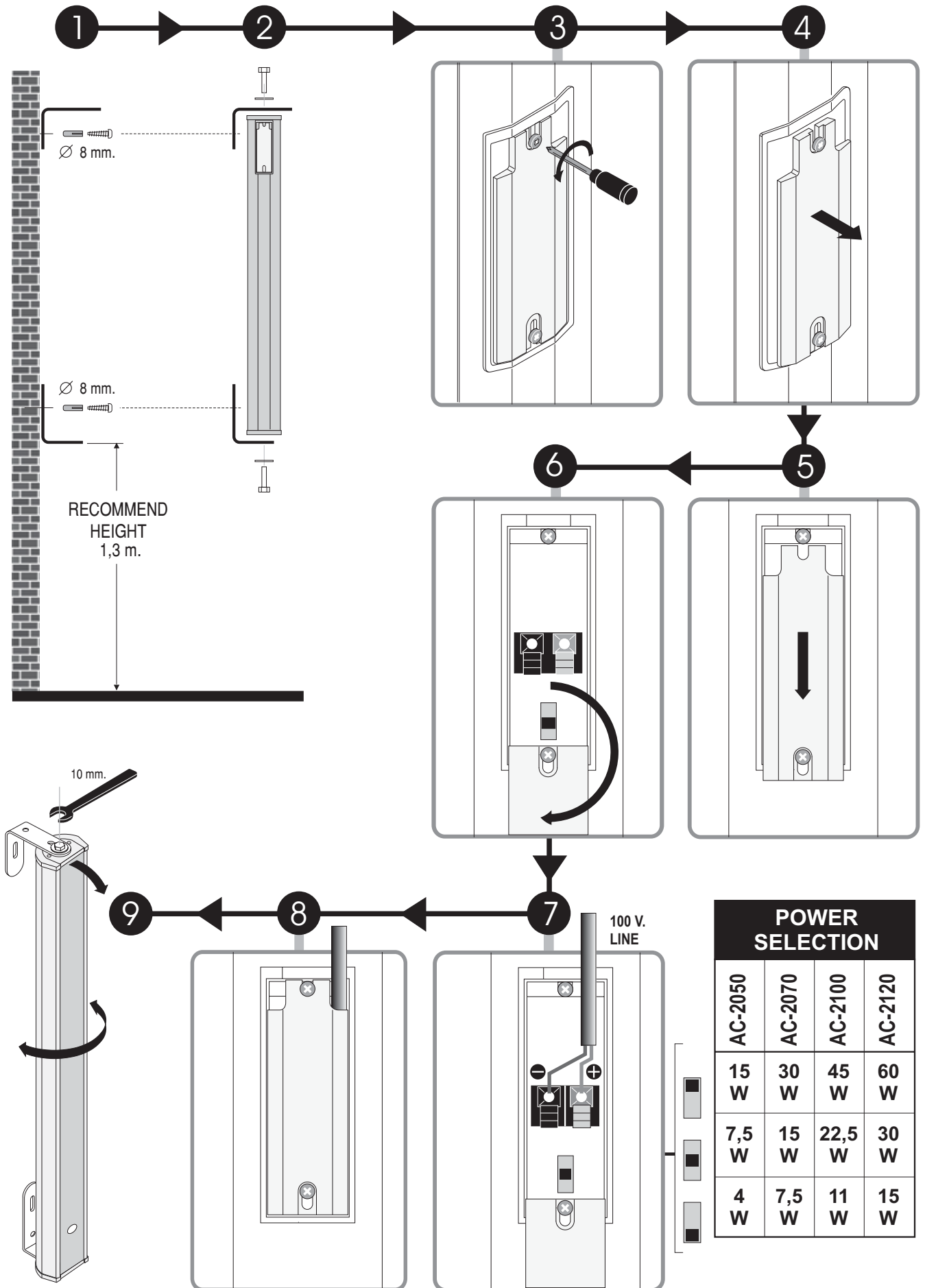

POWER SELECTION			
AC-2050	AC-2070	AC-2100	AC-2120
15 W	30 W	45 W	60 W
7,5 W	15 W	22,5 W	30 W
4 W	7,5 W	11 W	15 W

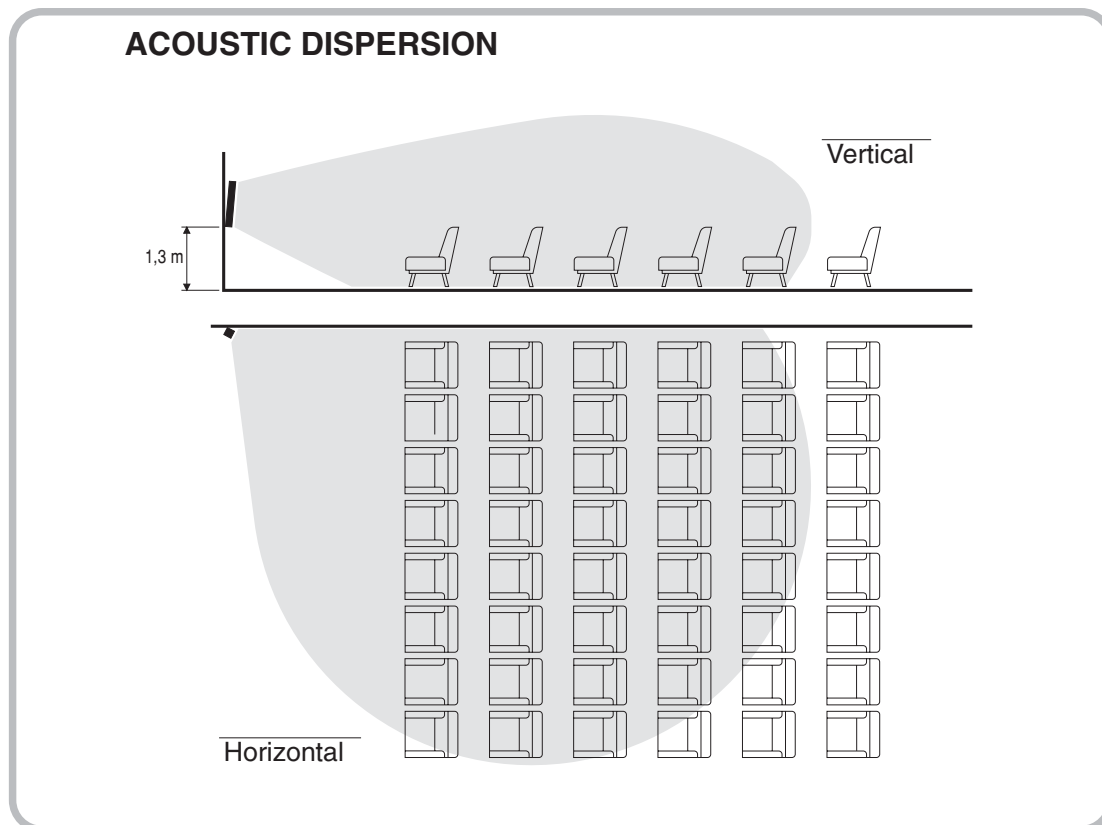

TECHNICAL CHARACTERISTICS

REFERENCE	AC-2050	AC-2070	AC-2100	AC-2120
- Product:	Column loudspeakers			
- Loudspeakers:	4	8	12	16
- Material:	Aluminium / ABS			
- Acoustic pressure (1W/1kHz/1m):	91 dB	95 dB	97 dB	99 dB
- Bandwidth:	150 Hz a 20.000 Hz			
- RMS Power:	15 W	30 W	45 W	60 W
- 100 V. line power:	15 - 7,5 - 4 W	30 - 15 - 7,5 W	45 - 22,5 - 11 W	60 - 30 - 15 W
- Dispersion angle HxV:	150 x 45 °	150 x 32 °	150 x 27 °	150 x 22 °
- Connection:	Pushbutton terminals			
- Power selector:	Thanks to linear commutator protected in the connection box.			
- Dimensions WxDxH (mm.):	63,5x50,5x434	63,5x50,5x662	63,5x50,5x952	63,5x50,5x1180
- Weight:	1,7 Kg.	2,5 Kg.	3,8 Kg.	4,6 Kg.